



Case Study #2

Automotive Service Center

Case Study #2

Automotive Service Center

Description

Over the course of nearly ten years, GFF has helped our client reimagine this well-situated warehouse to meet their evolving needs.

Purchased as a tractor parts and service facility, GFF designed the space as a Volvo service center in 2006. In 2008 we helped converted the space to function as a paintshop, and in 2010 we redesigned it as a McLaren workshop. In 2012 it was redesigned again to be the home of a motorsports operations, in addition to using the space as interior inventory storage. In 2014, we redesigned the space a final time to function as a conglomerated service facility for our automotive client’s local brands.

Program

18-vehicle	Service stalls	1,100 sf	Parts Storage Area
21-vehicle	Detail stalls	80-locker	Technician Restroom
6-vehicle	Wheel Repair stalls	48-seat	Technician Breakroom
3-vehicle	Tint stalls	800 sf	Office Space
3-vehicle	Paint-less Dent stalls	6	Paintbooths
3-vehicle	Wash stalls		

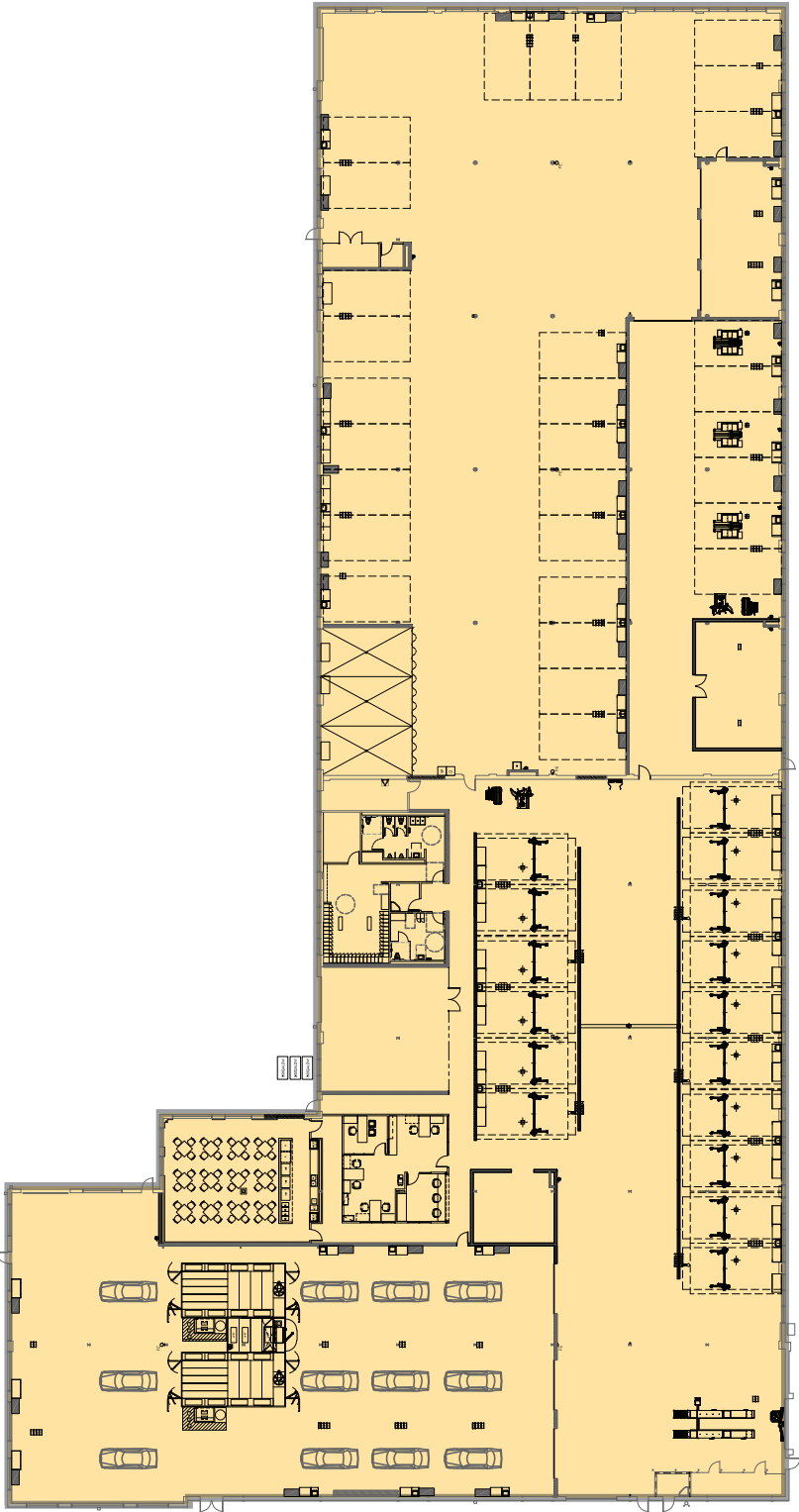

Case Study #2

Automotive Service Center



Case Study #2

Automotive Service Center



Case Study #2

Automotive Service Center



Case Study #2

Automotive Service Center





Creating Memorable Places